

# Rekonstrukce silnic III. třídy v Semilech

<p>Investor:</p>  <p><b>Liberecký kraj</b> U Jezu 642/2a 461 80 Liberec 2</p>	<p>Mandatář:</p>  <p><b>Krajská správa silnic Libereckého kraje,</b> příspěvková organizace České mládeže 632/32 460 06 Liberec 6</p>
--	---

Souřadnicový systém: S–JTSK  
Výškový systém: Bpv

**AKTUALIZACE DSP 2017**

Číslo zakázky: 14 098 00	HIP: Ing. J. ČAMROVÁ 241096760, jca@pontex.cz	 <p>Praha 4, Bezová 1658, 147 14 tel: +420 244062215 fax: +420 244461038</p>
Schválil: Ing. Václav HVÍZDAL	Zodp. projektant: Ing. Miloš NOVÁK 241096731, mno@pontex.cz	
Tech. kontrola: Ing. Petr DRBOHLAV 241096753, pdr@pontex.cz	Vypracoval: Ing. Martin NEUDERT 241096760, mne@pontex.cz	

Objednatel: KSSLK p.o.	Obec: CHUCHELNA	Kraj: Liberecký
Akce: REKONSTRUKCE SILNICE III/2923 CHUCHELNA	Datum: 02/2017	Stupeň: DSP
Část: STAVEBNÍ OBJEKTY	Souprava	Č. přílohy
Objekt: S0101.1 – SJEZDY		
Příloha: SJEZD NA POZEMEK KN 3628/1	7.4	

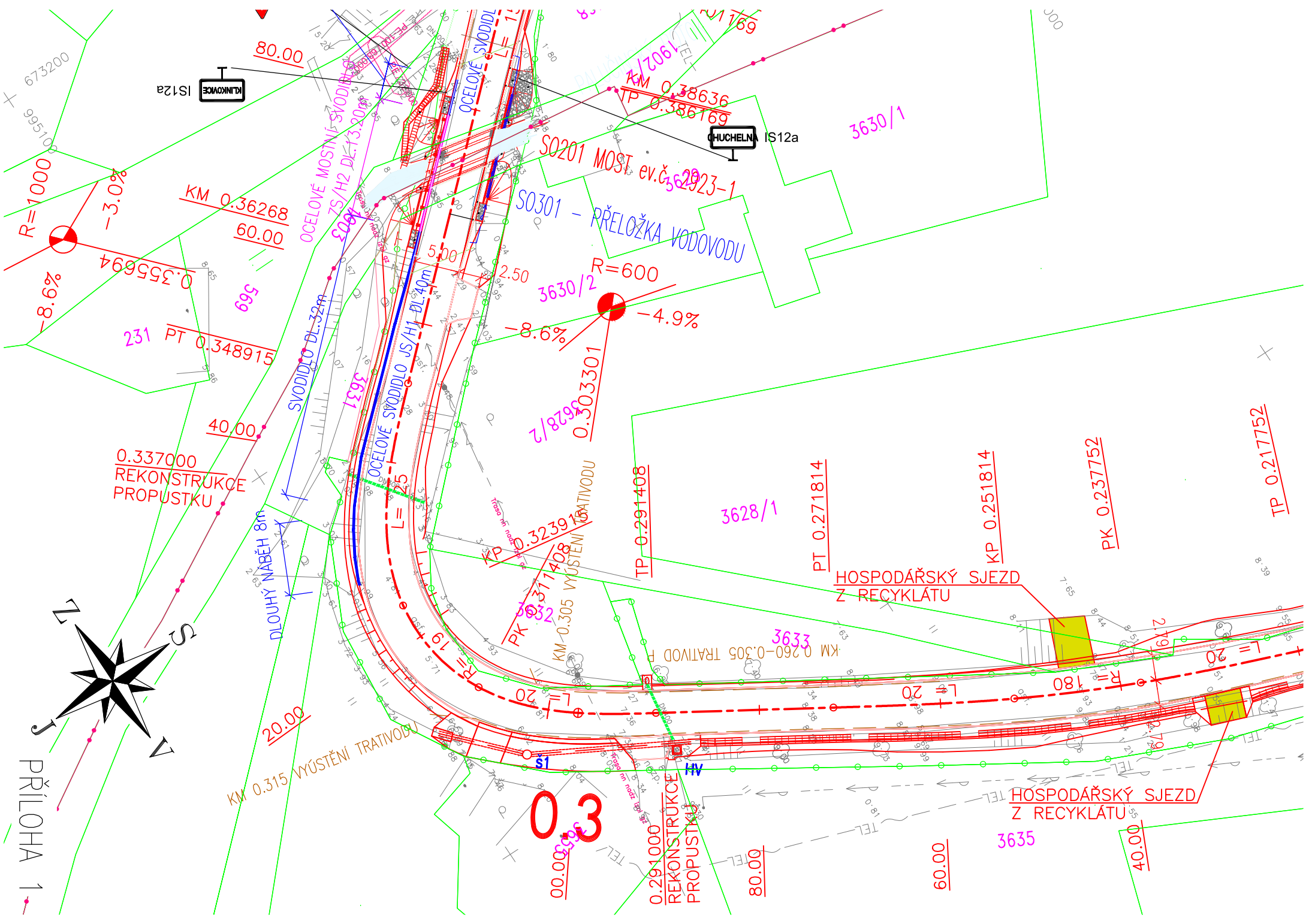
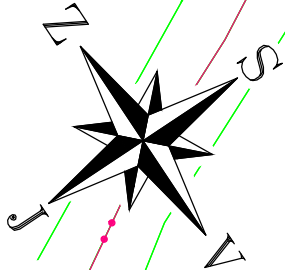

0.337000  
REKONSTRUKCE  
PROPUSTKU

KM 0.315 VYÚSTĚNÍ TRATIVODU

DLOUHÝ NABĚH 8m

OCELOVÉ SVODIDLO JS/H1 DL: 40m

OCELOVÉ SVODIDLO JS/H2 DL: 13.20m

OCELOVÉ SVODIDLO JS/H2 DL: 13.20m

0.3

0.291000  
REKONSTRUKCE  
PROPUSTKU

TP 0.291408

KP 0.317408

KM 0.305 VYÚSTĚNÍ TRATIVODU

KP 0.323914

TP 0.303301

R=600

3630/2

S0301 - PŘELOŽKA VODOVODU

S0201 MOST ev.č. 362923-1

TEL

KLINOVCE IS12a

HUHELNA IS12a

HOSPODÁŘSKÝ SJEZD  
Z RECYKLÁTU

HOSPODÁŘSKÝ SJEZD  
Z RECYKLÁTU

PT 0.271814

KP 0.251814

PK 0.237752

TP 0.217752

3628/1

3633

3630/1

3635

20.00

60.00

40.00

69.5

60.00

80.00

80.00

60.00

40.00

R=1000

-3.0%

-8.6%

-8.6%

-4.9%

0.355694

0.348915

0.337000

0.317408

0.323914

0.303301

0.38636

0.386169

0.36268

0.355694

0.348915

0.337000

0.317408

0.323914

0.303301

0.38636

0.386169

0.36268

0.355694

0.348915

0.337000

0.317408

0.323914

0.303301

0.38636

0.386169

0.36268

0.355694

0.348915

0.337000

0.317408

0.323914

0.303301

0.38636

0.386169

0.36268

0.355694

0.348915

0.337000

0.317408

0.323914

0.303301

0.38636

0.386169

0.36268

0.355694

0.348915

0.337000

0.317408

0.323914

0.303301

0.38636

0.386169

0.36268

0.355694

0.348915

0.337000

0.317408

0.323914

0.303301

0.38636

0.386169

0.36268

0.355694

0.348915

0.337000

0.317408

0.323914

0.303301

0.38636

0.386169

0.36268

0.355694

0.348915

0.337000

0.317408

0.323914

0.303301

0.38636

0.386169

0.36268

0.355694

0.348915

0.337000

0.317408

0.323914

0.303301

0.38636

0.386169

0.36268

0.355694

0.348915

0.337000

0.317408

0.323914

0.303301

0.38636

0.386169

0.36268

0.355694

0.348915

0.337000

0.317408

0.323914

0.303301

0.38636

0.386169

0.36268

0.355694

0.348915

0.337000

0.317408

0.323914

0.303301

0.38636

0.386169

0.36268

0.355694

0.348915

0.337000

0.317408

0.323914

0.303301

0.38636

0.386169

0.36268

0.355694

0.348915

0.337000

0.317408

0.323914

0.303301

0.38636

0.386169

0.36268

0.355694

0.348915

0.337000

0.317408

0.323914

0.303301

0.38636

0.386169

0.36268

0.355694

0.348915

0.337000

0.317408

0.323914

0.303301

0.38636

0.386169

0.36268

0.355694

0.348915

0.337000

0.317408

0.323914

0.303301

0.38636

0.386169

0.36268

0.355694

0.348915

0.337000

0.317408

0.323914

0.303301

0.38636

0.386169

0.36268

0.355694

0.348915

0.337000

0.317408

0.323914

0.303301

0.38636

0.386169

0.36268

0.355694

0.348915

0.337000

0.317408

0.323914

0.303301

0.38636

0.386169

0.36268

0.355694

0.348915

0.337000

0.317408

0.323914

0.303301

0.38636

0.386169

0.36268

0.355694

0.348915

0.337000

0.317408

0.323914

0.303301

0.38636

0.386169

0.36268

0.355694

0.348915

0.337000

0.317408

0.323914

0.303301

0.38636

0.386169

0.36268

0.355694

0.348915

0.337000

0.317408

0.323914

0.303301

0.38636

0.386169

0.36268

0.355694

0.348915

0.337000

0.317408

0.323914

0.303301

0.38636

0.386169

0.36268

0.355694

0.348915

0.337000

0.317408

0.323914

0.303301

0.38636

0.386169

0.36268

0.355694

0.348915

0.337000

0.317408

0.323914

0.303301